

00013

Mr. MURRAY.

REGRET only ONE COPY OF SKETCH
AVAILABLE.



1/2/11

With the Compliments of the
Political Adviser
Hong Kong

1/2/69.

one
Ref: FCO 40/157
Please note that this copy is supplied subject to the Public Record Office's terms and conditions and that your use of it may be subject to copyright restrictions. Further information is given in the enclosed Terms and Conditions of Supply of Public Records' leaflet.

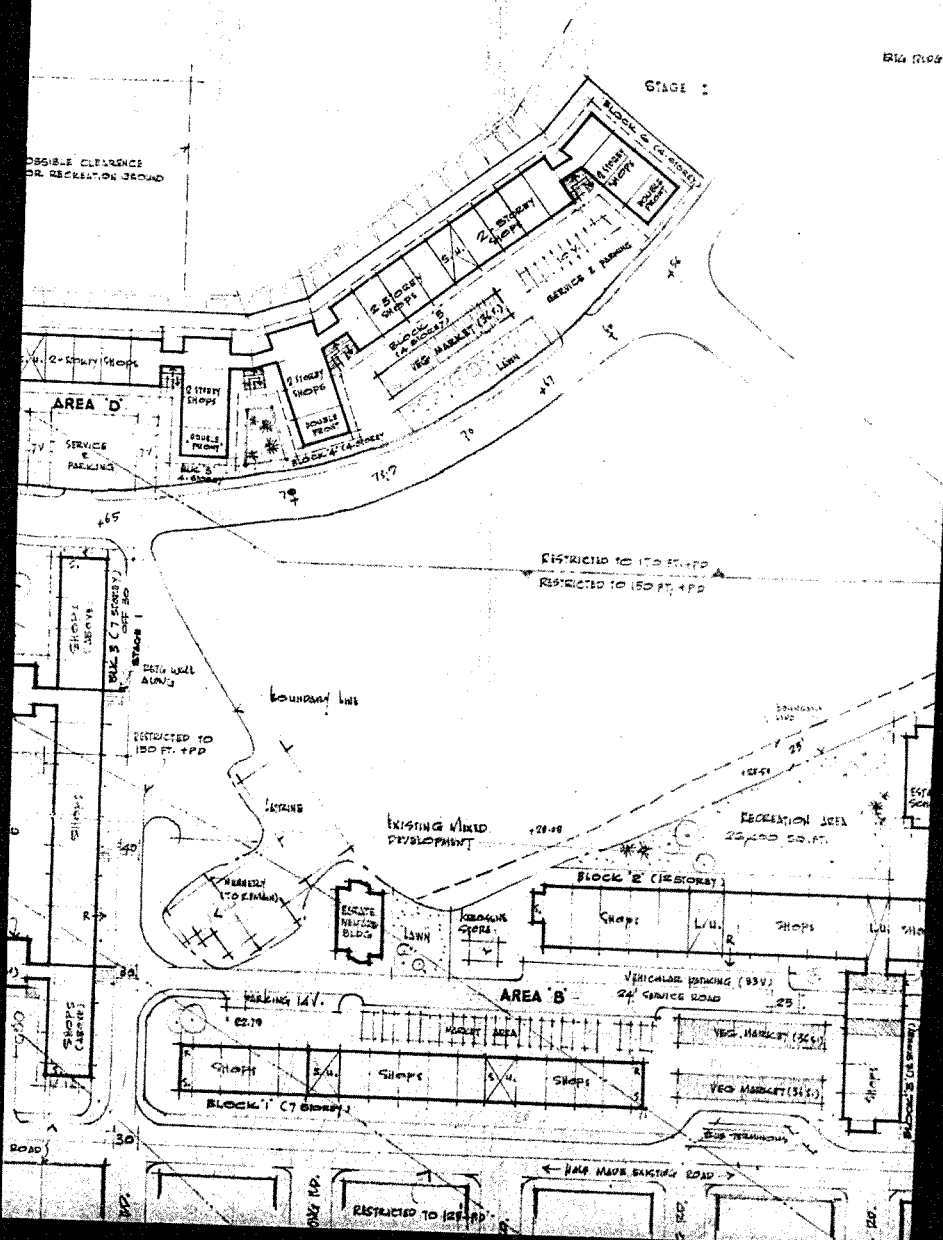

1
2
Ref: **FCO 40/157**
1
1
1
2

Plans contained hereon are prepared subject to the Public Record Office's terms and conditions and that your use of it may be subject to copyright legislation. Further information is given in the enclosed Terms and Conditions of Supply of Public Records Packlet.

000 16

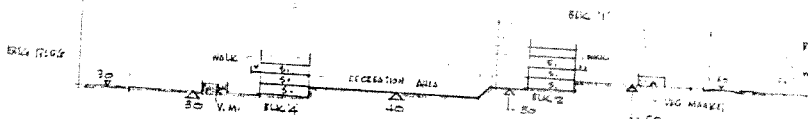

SECTION X-X

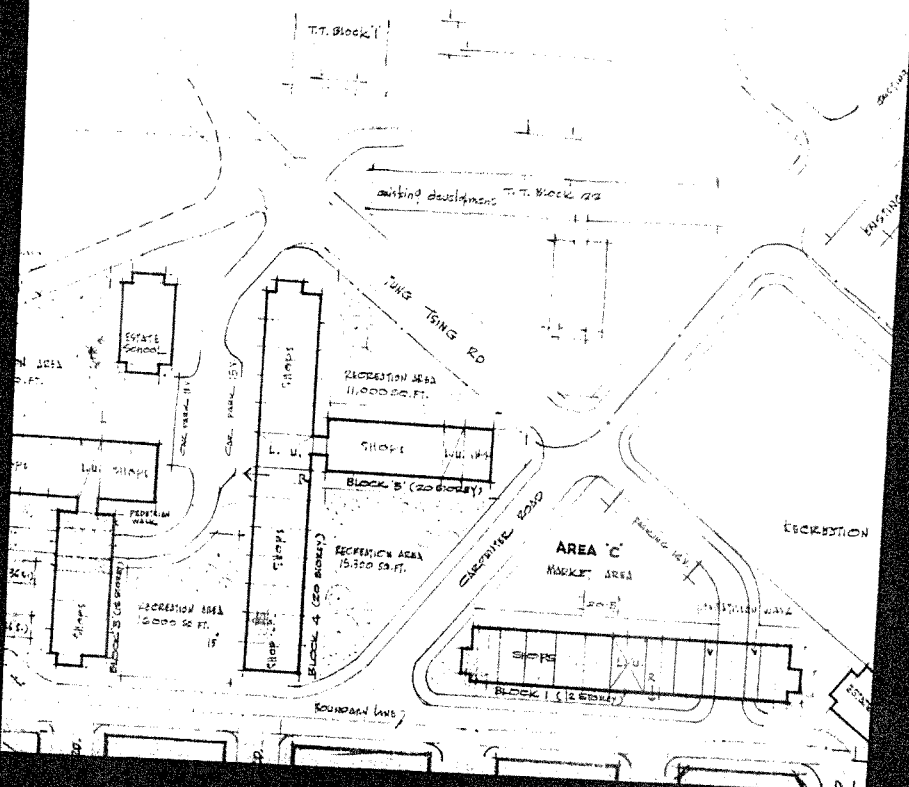

1
2
1
1
2

Planned under the Control of the Government of the Hong Kong Special Administrative Region and the Government of the People's Republic of China. Further information is given in the Technical Annex and the Schedule of Conditions of Sale of the Project.

Ref: **FCO 40/157**

1
2

00017

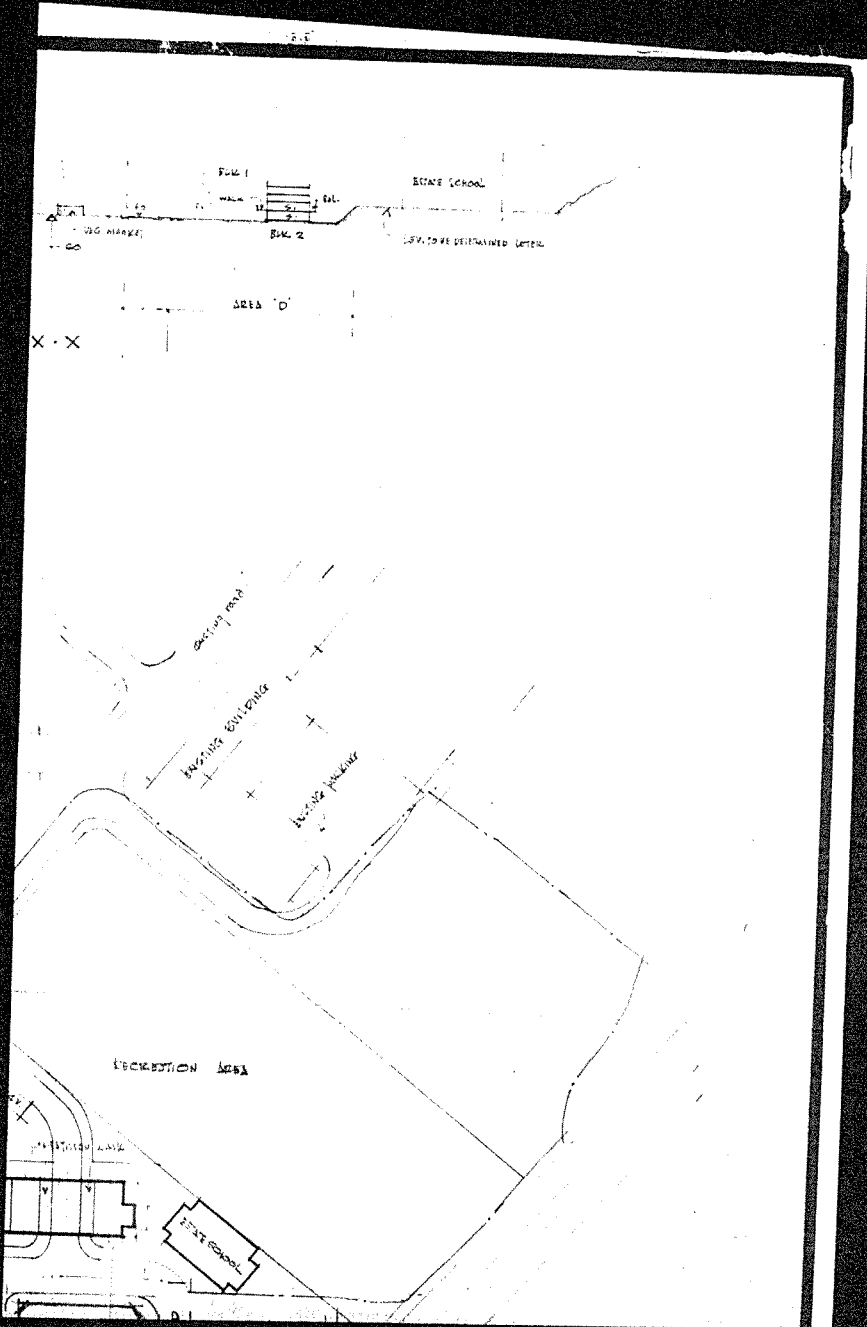

1	2	PUBLIC RECORD OFFICE		1	2
Please note that this copy is supplied subject to the Public Record Office's usual and standard conditions and may be subject to copyright restrictions. Further information is given in the enclosed Terms and Conditions of use of the Public Record Office's system.		Ref: FO 40/157		In: 2	

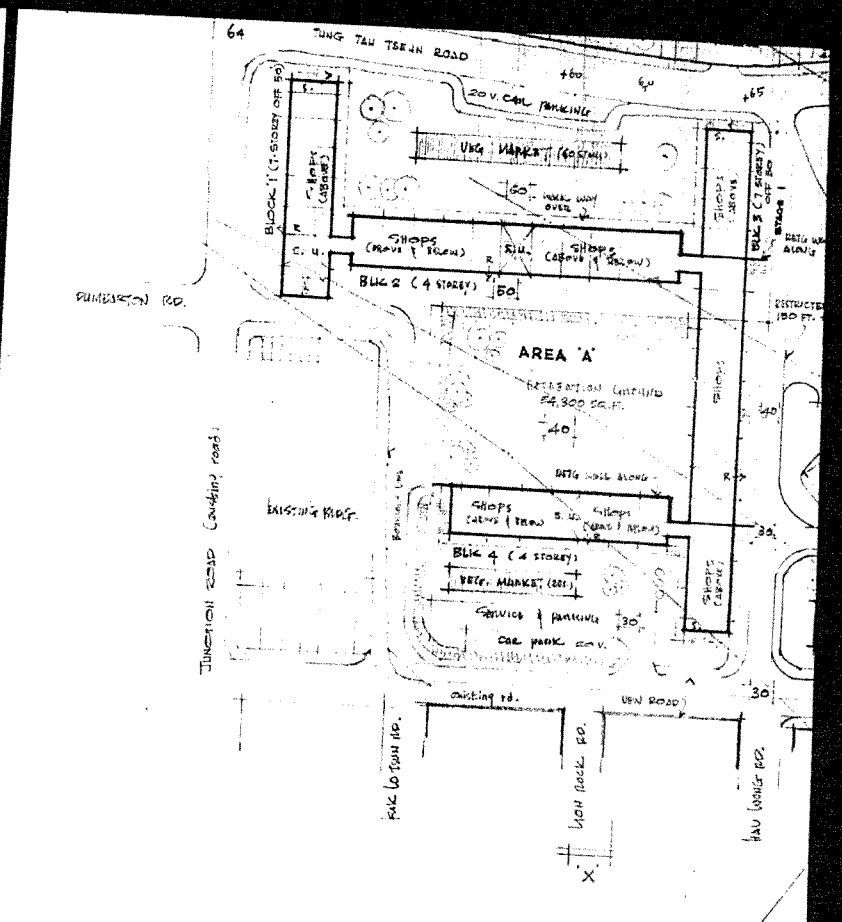

AREA 'A'

BLOCK 1	600
2	240
3	1,356
4	144
TOTAL	2,340

SHOPS (AREA A) = 193
 SHOPS (AREA B) = 177
 SHOPS (AREA C) = 30
 SHOPS (AREA D) = 164

TOTAL NO. OF SHOPS = 564
 TOTAL NO. OF SCHOOLS = 3
 VEGETABLE MARKET = 5 (196 STALLS)
 SOCIAL WELFARE BLDG = 1
 RECREATION GROUND = 2.8 ACRES
 TOTAL NO OF CAR PARKS = 151

CALCULATION OF POPULATION

AREA	Block	Population
AREA 'B'	1	1,992
	2	3,312
	3	1,324
	4	5,600
	5	2,400
TOTAL AREA 'B'		14,628
AREA 'C'	Block 1	2,704

GRAND TOTAL OF POPULATION = 21,140

PUBLIC RECORD OFFICE

1 2 1 2

Ref: **FCO 40/157**

1 2

1 2

Please note that this copy is subject to the Public Record Office's Terms and Conditions and that your use of it may be subject to copyright restrictions. Further information is given in the enclosed Terms and Conditions of Supply of Public Records forms.

00020

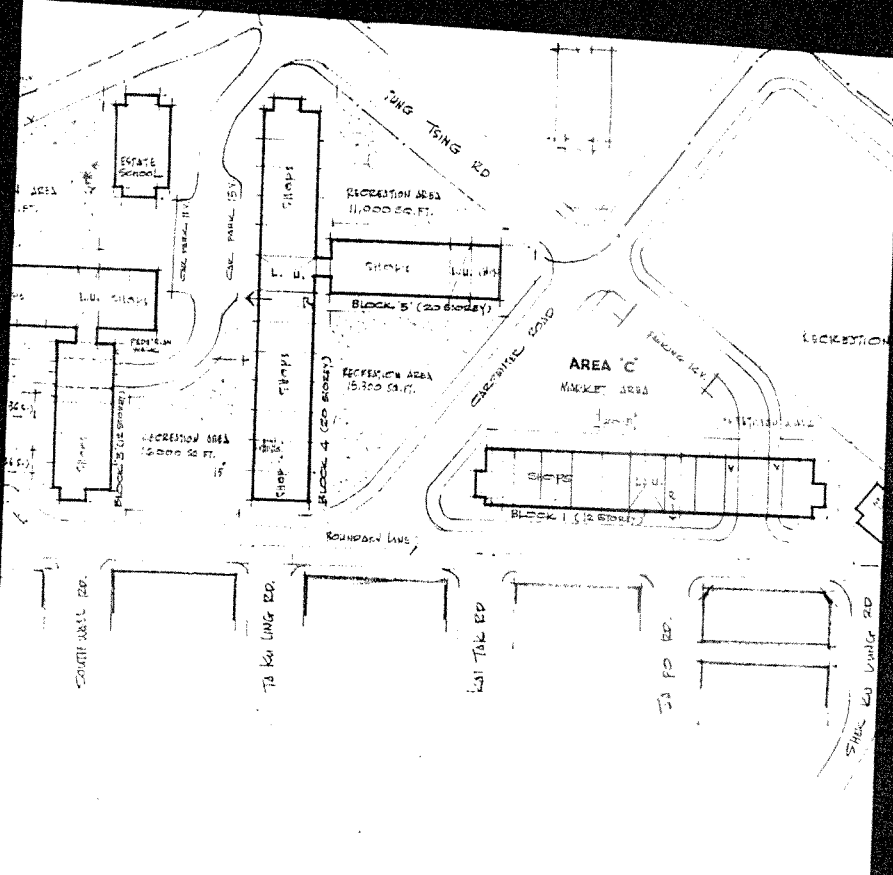

**SKETCH LAYOUT FOR RESETTLEMENT ESTATE
SITE AREA 'A', 'B', 'C' & 'D'.**

1 2
 Ref: **FCO 40/157**
 1 1
 1 2

Reasons given that the copy is a suspect subject to the Public Record Office's terms and conditions and that your use of it may be subject to copyright restrictions. If you wish to make use of this information please refer to the conditions, terms and conditions of supply of Public Records Online.

00021

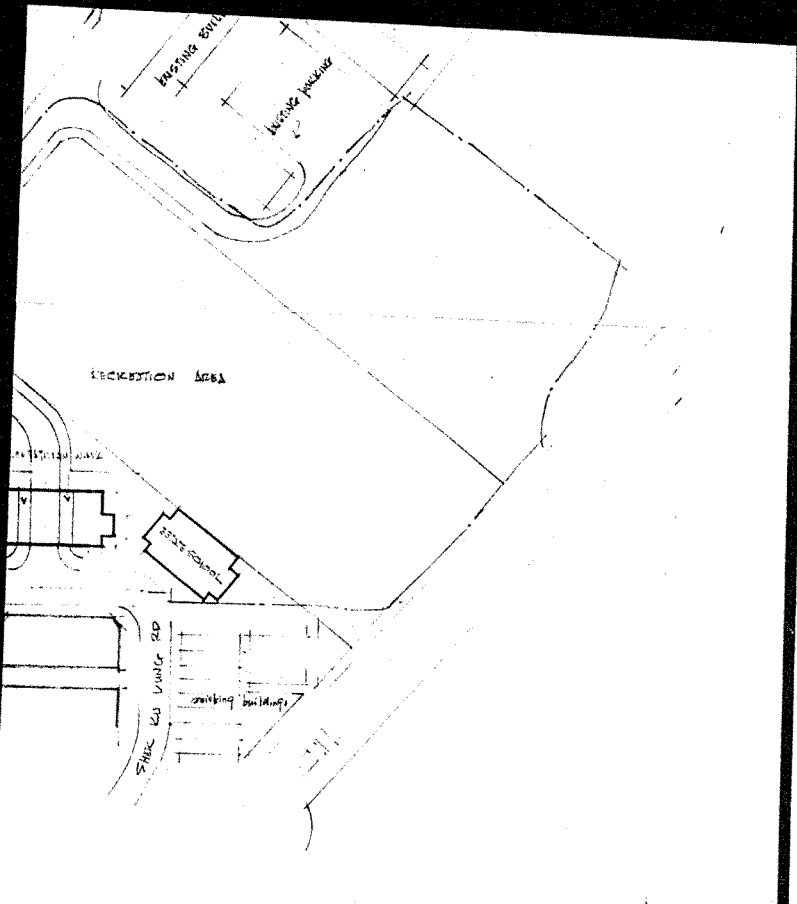

LEGEND:-
 R - RECREATION ROOM.
 S - STAIRCASE.
 C. U. - STAIRCASE UNIT.
 L. U. - LIFT UNIT.

DRG NO. A/31141

SCALE - ONE INCH TO 100 FT.

CHIEF ARCHITECT :-
 PROJECT ARCHITECT :-
 ARCHITECTURAL OFFICE P. W. D. H. K.

Thomas King 12.8.69

PUBLIC RECORD OFFICE

1	2	1	2
---	---	---	---

Ref: **RCO 40/157**

Plans made available are subject to the Public Record Office's terms and conditions and their use may be subject to copyright restrictions. Further information is given in the enclosed Terms and Conditions of supply of Public Record Office.